

bonaVITA

BV4000ID Porcelain Immersion Coffee Dripper

Customer assistant line:

USA/Canada 1-855- 664 -1252 or email customerservice@bona-vita.biz

Thanks for your purchase of the Steeping filter, read the manual carefully to operate the steeping filter for pour over coffee brewing.

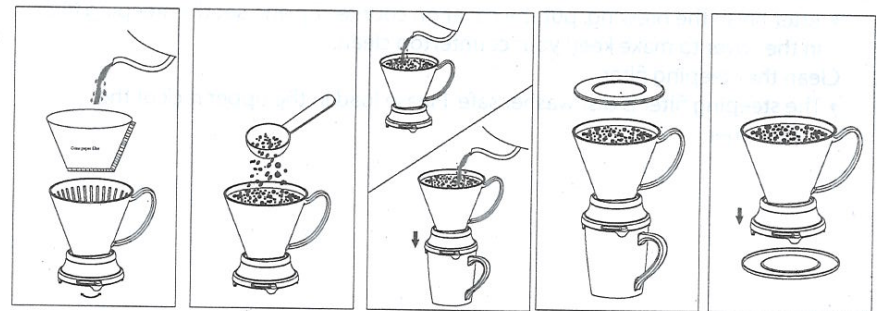
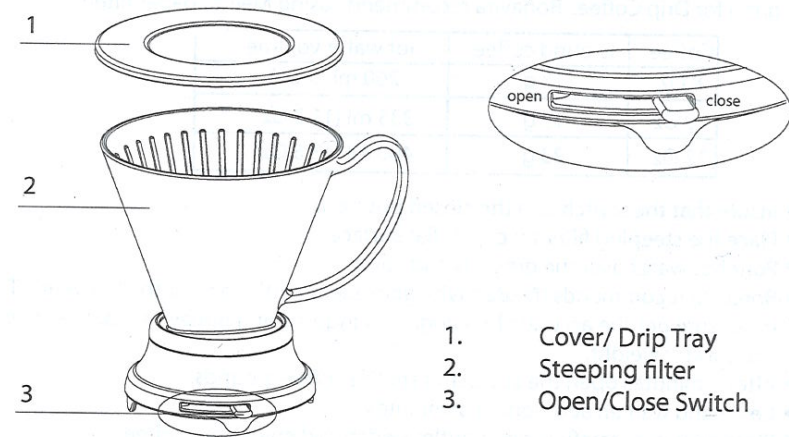

Close Switch , Put the paper filter in and pour a small amount of hot water to wet

add desired ground coffee

put steeping filter on a flate surface or on a cup to pour hot water

cover and wait, open switch to release coffee

Close switch and put on cover on countertop

1. Remove all the packaging and take out all components from package and clean carefully.
2. Follow the steps to brew coffee.
 - Insert the #4 cone paper filter in the steeping filter
 - For best results rinse your filter and preheat the Steeping filter:
 - Insure the switch is in the closed Position
 - Pour hot water over the paper filter and seeping filter wetting the paper and filling the filter to ½ full.
 - Position the Steeping filter over the sink or cup, open the switch and drain out the water.
 - Remember to close switch when draining is complete.
 - Scoop in your favorite ground coffee in the filter. The coffee should be coarse grind for Drip Coffee. Bonavita recommends using Melitta paper filters.

Coffee	Ground coffee	Hot water volume
8 Oz	15 g	260 ml (9 Oz)
10 Oz	19 g	335 ml (11.3 Oz)
12 Oz	23 g	400 ml (13.5 Oz)

- Insure that the Switch is in the closed position.
 - Place the steeping filter on cup or flat surface.
 - Pour hot water over the grounds and cover.
 - Bonavita recommends the Bonavita gooseneck kettle to pour the hot water. To make sure get the accurate brewing, we suggest using Bonavita Scale to measure your water weight.
 - After 2 minutes open the cover and stir the coffee grounds.
 - Cover and wait an additional 1-2 minutes.
 - Place over cup, carefully open outlet switch and enjoy your coffee.
 - You can increase or decrease the steeping time depending on your taste preference.
 - After finish the brewing, put the cover on countertop and set the steeping filter in the cover to make keep your countertop clean.
3. Clean the steeping filter
 - The steeping filter is dishwasher safe. Please load in the upper rack of the dishwasher.