

Saeco®

Magic

de luxe



OPERATING INSTRUCTIONS

Read these operating instructions carefully before using the machine

TYPE SUP012 R

FOR HOUSEHOLD USE ONLY

CE

IMPORTANT SAFEGUARDS

When using electrical appliances, basic safety precautions should always be followed to reduce the risk of fire, electric shock, and/or injury to persons, including the following:

- 1 Read all instructions and information in this instruction book and any other literature included in this carton referring to this product before operating or using this appliance.
- 2 Do not touch hot surfaces. Use handles or knobs.
- 3 To protect against fire, electric shock and personal injury do not immerse cord, plugs or appliance in water or other liquid.
- 4 Close supervision is necessary when any appliance is used by or near children.
- 5 Unplug from outlet when not in use and before cleaning. Allow to cool before putting on or taking off parts, and before cleaning the appliance.
- 6 Do not operate any appliance with a damaged cord or plug or after the appliance malfunctions or has been damaged in any way. Return appliance to the nearest authorized service centre for examination, repair or adjustment.
- 7 The use of accessory attachments not recommended by the appliance manufacturer may result in fire, electric shock or personal injury.
- 8 Do not use outdoors.
- 9 Do not let cord hang over edge of table or counter, or touch hot surfaces.
- 10 Do not place on or near a hot gas or electric burner, or in a heated oven.
- 11 Always turn appliance **"OFF"**, then plug cord into the wall outlet. To disconnect, turn switch to **"OFF"**, then remove plug from wall outlet.
- 12 Do not use appliance for other than intended household use.
- 13 Use extreme caution when using hot steam.

SAVE THESE INSTRUCTIONS

CAUTION

This appliance is for household use. Any servicing, other than cleaning and user maintenance, should be performed by an authorized service centre. Do not immerse base in water. To reduce the risk of fire or electric shock, do not disassemble the base. There are no user serviceable parts inside. Repair should be done by authorized service personnel only.

- 1 Check voltage to be sure that the voltage indicated on the nameplate agrees with your voltage.
- 2 Never use warm or hot water to fill the water tank. Use cold water only.
- 3 Keep your hands and the cord away from hot parts of the appliance during operation.
- 4 Never clean with scouring powders or hard implements. Simply use a soft cloth dampened with water.
- 5 To avoid your coffee maker scaling up, use purified or bottled water.

INSTRUCTIONS FOR THE POWER SUPPLY CORD

- A A short power-supply cord is provided to reduce risks of getting tangled up or tripping over a longer cord.
- B Longer extension cords are available and may be used if care is exercised in their use.
- C If a long extension cord is used:
 - 1 the marked electrical rating of the extension cord should be at least as great as the electrical rating of the appliance.
 - 2 if the appliance is of the grounded type, the extension cord should be a grounding type
 - 3 the cable does not hang from the table to avoid the risk of getting caught up in it.

GENERAL INFORMATION

This coffee machine is ideal for preparing espresso coffee either with coffee beans or preground coffee and also features a device for dispensing steam and hot water. This elegantly styled machine is designed for household use only. It is not suitable for continuous professional-type use.

Warning. The manufacturer shall accept no liability for damage or injury caused by:

- **improper use or use for other than the intended purposes;**
- **repairs carried out by anyone other than an authorised service centre;**
- **tampering with the power cord;**
- **tampering with any machine component;**
- **use of spare parts and accessories other than those supplied by the manufacturer.**

The warranty will be invalidated in such cases.

TO FACILITATE INTERPRETATION



A warning triangle draws attention to the instructions that are important for user safety. Please carefully abide by these instructions to avoid serious injury!

HOW TO USE THESE OPERATING INSTRUCTIONS

Keep these operating instructions in a safe place and make them available to anyone else who should use the coffee machine. For further information or an explanation of problems not completely or sufficiently addressed in these instructions, contact an authorised service centre.

TECHNICAL SPECIFICATIONS

• Voltage rating	See rating plate on appliance
• Power rating	See rating plate on appliance
• Casing material	Metal
• Size (w x h x d) (mm)	385 x 395 x 455 (Version: Silver) 340 x 395 x 410 (Version: Black)
• Weight (Kg)	13
• Cord length (mm)	1200
• Control panel	Front (Digital)
• Water tank (lit.)	2,4 - Extractible
• Power supply	See rating plate on appliance
• Coffee container capacity (g.)	300 of coffee beans
• Pump pressure (bars)	15
• Boiler	Stainless steel
• Safety devices	Boiler pressure safety valve safety thermostat

Subject to engineering and manufacturing changes as warranted by technological developments.

Machine in conformity with European Directive 89/336/EEC (Italian Legislative Decree 476 of 04/12/92) concerning electromagnetic compatibility.

IN THE EVENT OF AN EMERGENCY

Immediately unplug the appliance.

THE APPLIANCE MAY ONLY BE USED

- In a closed place.
- To prepare coffee, dispense hot water, froth milk or heat beverages using steam.
- For household use.
- By adults in full possession of their physical and mental capacities.

NEVER USE THE APPLIANCE

for purposes other than those indicated above to avoid hazards. Never place any substances in the containers other than those specified in the instruction manual. When you fill a container, make sure all nearby containers are closed. Fill the water tank only with fresh drinking water: hot water and/or other liquids may damage the machine. Do not use carbonated water. The coffee grinder may be adjusted only while it is running. Do not introduce your fingers or any material other than coffee beans into the coffee grinder. Before attempting to access the inside of the coffee grinder, switch OFF the machine and remove the plug from the electric socket. Do not put coffee beans or instant coffee into the ground coffee container.

MAINS CONNECTION

Connect the coffee machine to a suitable electric socket. The voltage must match the voltage specified on the appliance rating plate.

INSTALLATION

- Choose a perfectly level supporting surface. Do not place on a hot surface!
- Maintain a distance of 10 cm from walls and electric or gas burners.
- Do not keep at temperatures below 0 °C; the appliance may be damaged by freezing.
- The electric socket must be accessible at all times.
- The power cord must not be damaged, secured with clamps, placed on very hot surfaces etc.
- Do not let the power cord hang loosely (Warning: danger of tripping or of causing the appliance to fall).
- Do not use the power cord to carry or pull the coffee machine.

HAZARDS

- The appliance must not be used by children or by individuals unacquainted with the operating instructions.
- The appliance is dangerous for children. If left unattended it must be switched off.
- Do not leave the materials used to pack the appliance within children's reach.
- Do not direct a jet of hot steam and/or hot water toward yourself or others: danger of scalding.
- Do not introduce any objects through the openings in the appliance (Electrical hazard!).
- Do not touch the plug when your hands or feet are wet. Do not unplug the appliance by yanking at the power cord.
- Warning: contact with hot water, steam or and hot water/steam nozzle may cause burns.

FAULTS

- Do not use the appliance if it malfunctions or you suspect damage, e.g. after a fall.
- Repairs must be performed by an authorised service centre.
- Do not use an appliance with a defective power cord. The cord may be replaced exclusively by a service centre (Electrical hazard!).
- Switch off the appliance before opening the service door. Danger of burns!

CLEANING / DESCALING

- Before cleaning the appliance, unplug it and allow it to cool down.
- Avoid exposing the appliance to splashes of water. Do not immerge it in water.
- Do not dry machine components in a conventional or microwave oven.

SPARE PARTS

To guarantee safety, you should use only original spare parts and accessories.

DISPOSAL

- The packing materials can be recycled.
- Appliance: unplug the appliance and cut the power cord.
- Deliver the appliance and power cord to a service centre or public waste disposal facility.





If necessary, remove the swivel ring from the packing container and fit it into the machine.



Remove the drip tray from the packing container and fit it into the machine.



Fill the coffee bean container with coffee beans.



Fill the tank with fresh drinking water.



See rating plate

Insert the plug into a suitable electric socket.



Move the ON/OFF switch to "I" to turn on the machine.



The machine is warming up; the light remains off.



Place a container beneath the steam tube.



Turn the knob counterclockwise to start loading the circuit.



Wait until a steady stream of water flows out from the nozzle.



Turn the knob clockwise to terminate the circuit-loading process.



Remove the container.



When the light goes on, the machine is ready for use.

Note: You must load the circuit before starting up the machine for the first time, if it has been inoperative for a lengthy period or if the water tank has been completely emptied. Moreover, the circuit must be loaded whenever the indicator light flashes:

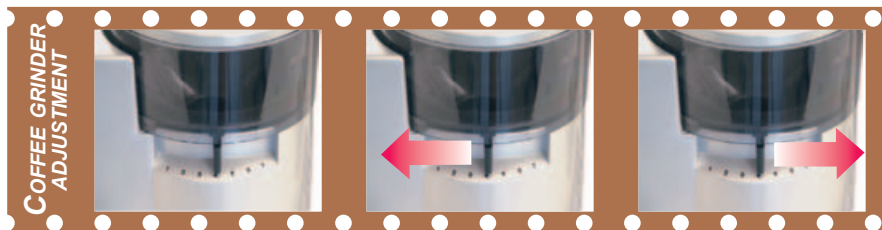

**COFFEE GRINDER
ADJUSTMENT**

The fineness of the grind may be adjusted using the lever.

Coffee flows out more slowly

Coffee flows out more quickly



Adjustment may be made only while the coffee grinder is operating.

Use coffee bean blends for espresso coffee makers. If you do not obtain the desired result, try using different coffee blends. Store coffee in a cool place, in a hermetically sealed container.

You will note a change after dispensing 3 – 4 coffees.

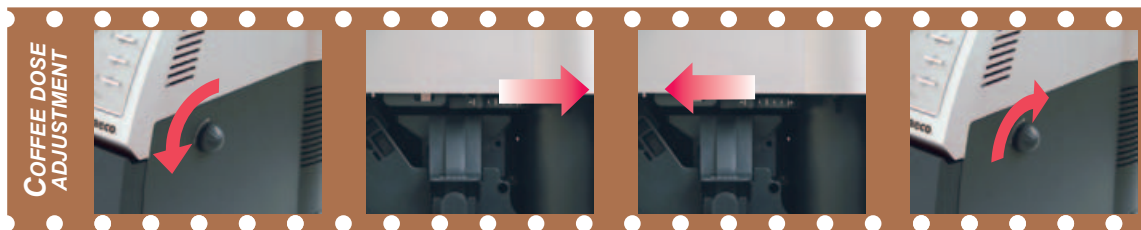
**COFFEE DOSE
ADJUSTMENT**

You can adjust the quantity of coffee to be ground. Open the door.

Stronger coffee.

Weaker coffee.

On completing the adjustment, close the door.

You must adjust the dose before dispensing coffee.

This adjustment will have an immediate effect on the coffee brewed.

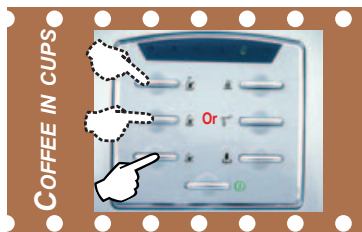
COFFEE IN CUPS

To adjust the quantity of coffee dispensed to the size of your cups, place a cup beneath the brew unit, press the button corresponding to the type of coffee desired and **keep it pressed while coffee is being dispensed.**

When the cup has filled to the desired level, release the button; the machine is now programmed to dispense the quantity of coffee you have chosen.

COFFEE BEANS



Make sure that the machine is ready.

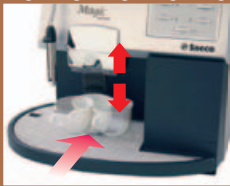

Position a warm coffee cup or cups beneath the brew unit.

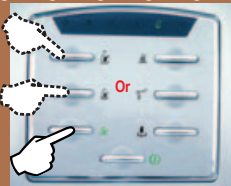

Press the button of the type of coffee desired. Once for 1 coffee

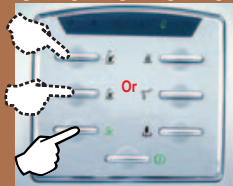

Twice for 2 coffees.



When the machine stops making the coffee, remove the cup or cups.

PREGROUND COFFEE



Position a warm coffee cup beneath the brew unit.



Select the product "Preground coffee".



Introduce ground coffee using the coffee measure. **MAX 1 MEASURE**

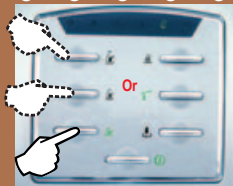

Press the button of the type of coffee desired.



When the machine stops making the coffee, remove the cup.

HOT WATER



Place a container beneath the steam tube.



Turn the knob counter-clockwise to start dispensing water.



Wait



When you reach the desired amount, close the knob.



Remove the container.



Warning: hot water and steam can cause burns!

CAPPUCCINO



Fill a cup to 1/3 with cold milk.



Press the button to select the function. The machine will warm up.



When the light goes on, the machine will be ready to dispense steam.



Open the knob to discharge any residual water.



When only steam comes out, close the knob.



Position the cup containing milk beneath the steam tube.



Open the knob to release steam.



Move the cup in a circular fashion to heat the milk evenly.



After frothing the milk, close the knob.



Remove the cup.



Press the coffee button. The light will flash.



Place a container beneath the steam tube.



Open the knob and dispense hot water.



When the light remains steadily lit, close the knob and remove the container.



Dispense coffee into the cup to prepare a delicious cappuccino.

Warning: hot water and steam can cause burns!

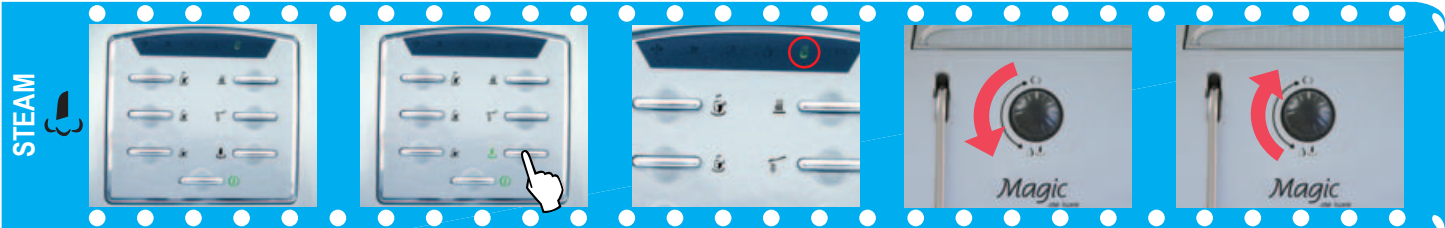

Check the machine status.

Press the button to select the function. The machine will start warming up.

When the light goes on, the machine will be ready to dispense steam.

Open the knob to eliminate any residual water.

When only steam comes out, close the knob.



Take the container and position it under the hot water/steam tube.

Open the knob to release steam.

Move the container in a circular fashion to heat evenly.

After you have finished, close the knob.

Remove the container.



Press the button to restore the machine to normal operation. The light will flash.

Place a container beneath the steam tube.

Open the knob and dispense hot water.

When the light remains steadily lit, close the knob and remove the container.

The machine is ready to dispense coffee.

Warning! Never use vinegar as a descaling agent. You can use any commercially available non-toxic, non-harmful descaling product for coffee machines. We recommend using a Saeco descaling agent.

The machine must be descaled every 3-4 months, when you observe a diminished flow of water or when the machine signals that descaling is necessary. The machine must be on; it automatically controls the distribution of the descaling solution.

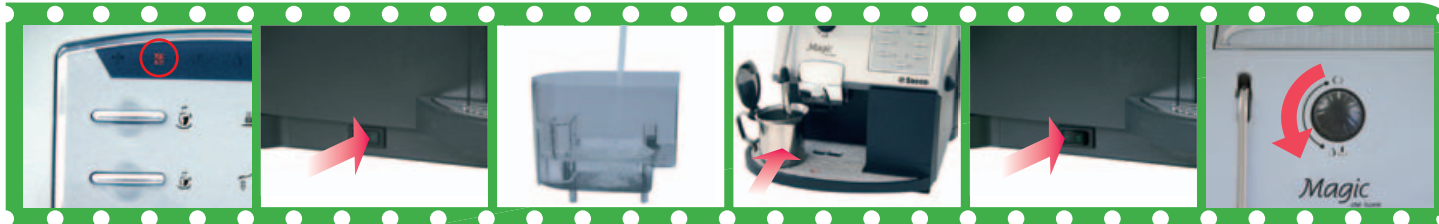

When the machine needs descaling, the indicator goes on.

Switch off the machine.

Fill the water tank with the descaling solution.

Place a large receptacle beneath the steam tube.

Switch on the machine

Turn the knob to open the valve. The machine will start descaling.

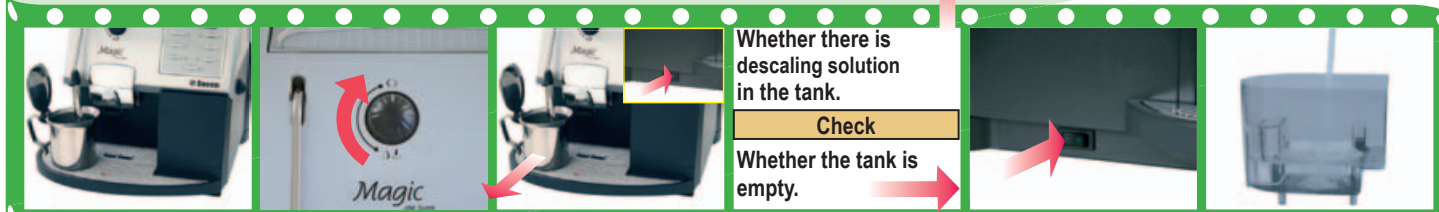

Dispense the descaling solution into the receptacle.

After about 30 seconds close the valve.

Switch off the machine and remove the receptacle.

After 10 minutes.

Switch on the machine.

Rinse out the tank and fill it with fresh drinking water.



Place a large receptacle beneath the steam tube.

Open the valve to rinse.

If the receptacle fills, empty it.

When no water is left, turn the knob to close the valve. Remove the container.

Press the button for 5 seconds. The indicator will go off.

! If the descaling cycle is interrupted, the water tank and internal machine circuits must be rinsed.

After descaling the machine, reload the machine circuit.

Do not dry the machine and/or its components in a microwave and/or conventional oven.

Do not immerge the machine in water and do not place any of its components in a dishwasher.



**BASIC
CLEANING**

Turn the machine off.
Unplug the machine.

Wash the water tank.
Wash the filter inside it.

Use the brush to clean the
ground coffee dispenser.

Remove the drip tray, empty
it out and wash it.

Remove the dregs drawer,
empty it out and wash it.

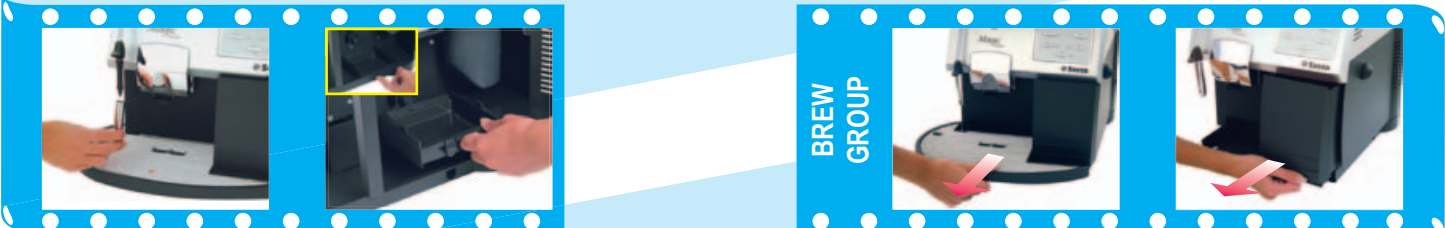

**BREW
GROUP**

Unscrew the "pannarello"
(steam tube attachment)
and clean it.

Remove the coffee grounds
drawer.

Remove the drip tray.

Remove the dregs drawer.



Open the side door.

Press the PRESS button to
release the brew group.

Unscrew the upper filter
and wash it. Fit it back in
place when clean.

Wash the unit, dry it and
fit it back in place. Do not
press the "PRESS" button.

Set all machine components
back in position.
Close the door.

The user can change some machine operating parameters to suit his/her personal needs.



PROGRAMMING START

Switch off the machine to access the programming mode.

Press the buttons together.

While the buttons are pressed, switch on the machine.

On the control panel, the indicator lights corresponding to the functions activated will light up.

If you wish to exit, switch the machine off and then on again.



PREBREWING

With the pre-brewing process the coffee is slightly moistened before actual brewing. This brings out the full aroma of the coffee and lends it an excellent flavour. It is possible to choose either "enabled" or "disabled".

The function is enabled by pressing the button

Light on
Prebrewing = On

Light off
Prebrewing = Off



PREGRINDING

With the pre-grinding process the machine grinds twice: the first time for the type of coffee selected and the second time for the subsequent coffee (not yet selected). This function is useful when you want to reduce the time necessary for dispensing several coffees in sequence (e.g. while entertaining guests or during a party).

The function is enabled by pressing the button

Light on
Pregrinding = On

Light off
Pregrinding = Off

WATER HARDNESS

The hardness of tap water may vary depending on the region. For this reason, the appliance can be set according to the water hardness in the place where it is to be used, expressed on a scale of 1 to 4.



The appliance is factory set on a hardness value of 3. The setting should be adjusted according to the level of water hardness in the local area.

Dip the strip in water for 1 second.

Check how many squares change colour.



Press the button to set the hardness measured with the strip.

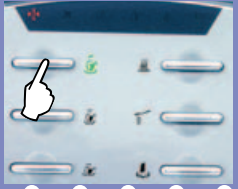

If 1 square changed colour, set:

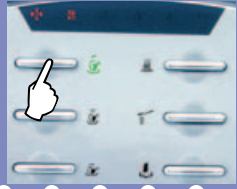

If 2 squares changed colour, set:

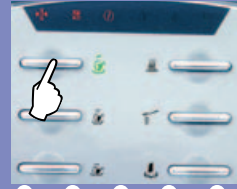

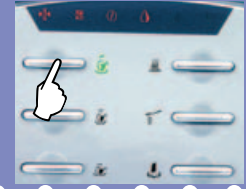

If 3 squares changed colour, set:





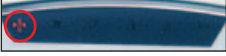

If 4 squares changed colour, set:

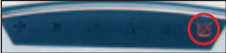
Horizontal lines for writing the settings for each hardness level.

The control panel display guides users and helps them to use the machine correctly.

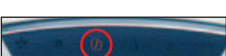
- 
Steadily lit Fit the brew unit properly in place.
- 
Flashing Brew unit jammed: contact an authorised service centre.
- 
Steadily lit Descale the machine
- 
Steadily lit Remove the dregs drawer and empty out the dregs into a suitable container.

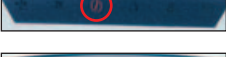
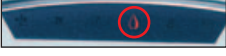
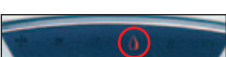
Important note: the dregs drawer may be emptied only when the machine is on. The drawer must be removed for at least 5 seconds. If you empty the drawer with the machine off, you will not be able to dispense coffee the next time you switch the machine on.

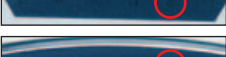
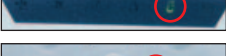
- 
Flashing Fit the drip tray and dregs drawer properly in place.
- 
Steadily lit Fill the coffee bean container with coffee beans and start the coffee brewing cycle.
- 
Flashing Coffee grinder jammed: contact an authorised service centre.
- 
Steadily lit Fill the water tank with fresh drinking water.
- 
Flashing Place a container beneath the steam tube and load the circuit as directed on page 6.
- 
Off Machine temperature low.
- 
Flashing Boiler temperature too high, load the circuit as directed on page 10.
- 
Steadily lit Power on.
- 
Flashing Machine in Stand By mode.

PROBLEMS	CAUSES	REMEDIES
The machine does not turn on.	The machine is not connected to the power supply.	Move the main switch to ON. Check the plug and the connection
The coffee is not hot enough.	The cups are cold.	Warm up the cups.
Only water is dispensed when you select "preground coffee".	No preground coffee has been introduced.	Dispense again after introducing preground coffee.
No hot water or steam is dispensed.	The tube nozzle is clogged.	Clean the nozzle opening with a needle. ⚠ During this operation, the knob must be closed and the machine must be off.
The machine takes a long time to warm up.	Excessive scale has built up.	Descale the machine.
The brew unit cannot be removed.	The unit has stopped in the wrong position.	Close the door and switch on the machine; the brew unit will move back into position.



Saeco International Group S.p.A. - Via Panigali, 39
40041 Gaggio Montano - Bologna - Italy
Tel. +39 0534.771.111 - Fax. +39 0534.31025 - <http://www.saeco.com>