

# bonavita®

## BV2000SC Bonvita Scale

Customer assistance line:

USA 1-855-664-1252 or Email: [customersupport@bonavitaworld.com](mailto:customersupport@bonavitaworld.com)

Thanks for your purchase of the Bonavita scale, read the manual carefully to operate the scale.

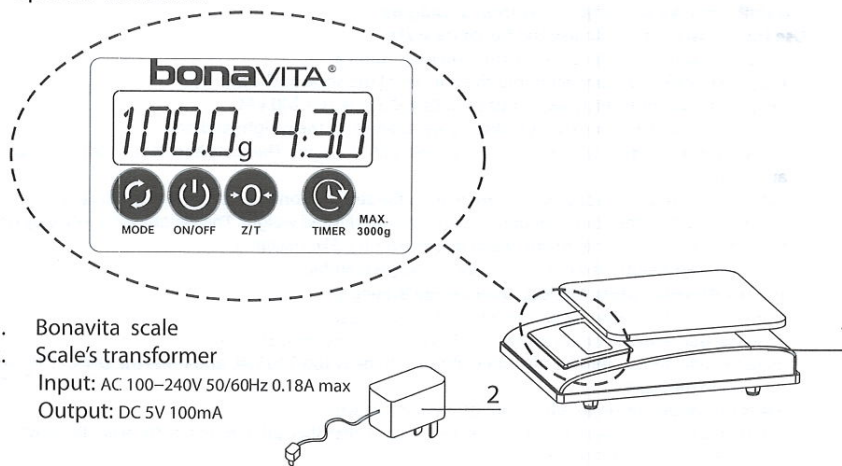

1. Bonavita scale
2. Scale's transformer

Input: AC 100–240V 50/60Hz 0.18A max  
Output: DC 5V 100mA

Scale weight range: 0.2g – 3.0 kg

Measure range 0.2g-500g tolerance is +/- 0.3 g\*

500g – 1000g tolerance is +/- 0.5 g\*

1000g – 3000g tolerance is +/- 1.0 g\*

\* tolerance test is measure in the center of scale

Measure speed: 1ms

Set up the Bonavita scale:

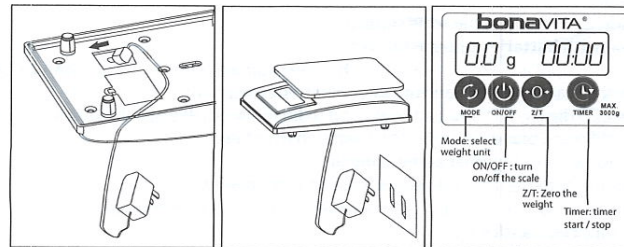

Change the batteries:

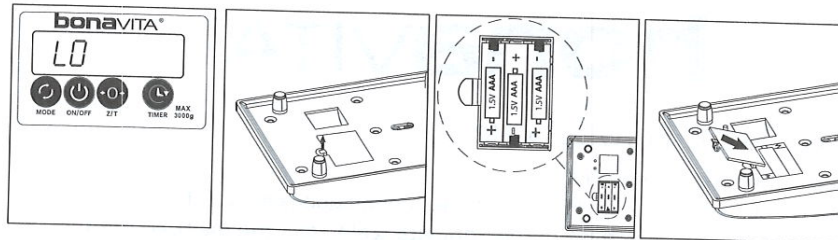

#### OPERATION

- Carefully remove all components from packaging**
- Use the following steps to use the Bonavita scale**
  - Put the Bonavita scale on a breeze free and level surface.
  - Plug the transformer connector into the bottom of the scale as shown.
  - Plug the transformer into a wall outlet whose voltage is 100-240 VAC.
  - Press the ON/OFF button. The LCD display will then show the weight and time.
  - Press the mode button to select your preferred unit of weight. The scale has three modes: oz., lb., and grams.
  - Put a container on the scale surface, then press the zero button to reset the weight to zero.
  - Add the goods to the container until you get to your desired weight. The weight will be display on the left of the LCD. Please do not weigh goods over the 3kg maximum.  
Note: You can weigh solid goods directly on the glass surface.
- Using the Bonavita Scale for Pour Over Coffee Brewing.**
  - Put the Bonavita scale on a breeze free and level surface.
  - Plug the transformer connector into the bottom of the scale as shown.
  - Plug the transformer into a wall outlet whose voltage is 100-240 VAC and press the ON/OFF button to turn on the scale.
  - Press the mode button to select your desired unit of weight.
  - Insert the correct size paper filter in the pour-over cone filter, then put the filter on the scale. Bonavita recommends Melitta paper filters.
  - Press the Z/T button to reset the weight to zero, then scoop in your favorite freshly ground coffee until you reach your desired weight.
  - Place the drip pan and drip cover on the scale.
  - Place a dripper stand with cup and filter on the dripper tray.
  - Press the Z/T button to reset the weight to zero.
  - Press the timer button on the scale to start count up timer and display on the right of the LCD display, press the timer button one more time to stop. Press the timer again will reset. The max time is 9 Min. 59 seconds.
  - Carefully pour hot water through the filter. The weight will be displayed on left of the LCD.
- Clean the scale**
  - Use the soft cloth to clean the scale surface.
- Use the scale with batteries or transformer**
  - Power can be supplied to the scale with either the supplied transformer or 3 AAA batteries.
  - Don't use the scale with the transformer and batteries together.
  - When the LCD display "LO" the batteries need to be replaced. Replace the batteries in the scale.
  - Don't mix different brands or styles of batteries in the scale.
  - Change the batteries together at the same time.
  - Make sure the batteries are inserted with the correct polarity.
  - If not in use for a longer period, please remove the batteries from the scale.
  - Only use supplied transformer.
  - Don't use the transformer in other products.
  - Disconnect the transformer when cleaning.
  - Don't use wet cloth to clean the transformer.